

NEW



FEKABOX 200

AUTOMATIC STATIONS FOR COLLECTING AND LIFTING WASTE WATER



Automatic collection and lifting stations, used for collecting and pumping civil and industrial waste water in sewers.

Comprises a high density 200 litre polythene tank with removable cover complete with a watertight and gastight seal.

Fitted for one automatic electric pump (**FEKA 600 M/A - FEKA VS 550 M/A - FEKA VS 750 M/A - FEKA VX 550 M/A - FEKA VX 750 M/A**) to be ordered separately.

Complete with: special cable holder, DN50 and DN110 suction manifolds and 2" delivery manifolds. Complete with connector for DN50 vent tube. An alarm float can be used on request.

Operating range: from 1 to 24 m³/h with a head of up to 9 m

Liquid temperature range: +50°C

Pumped liquid: ground water, rain water, clear waste water, black waste water and water from rivers and lakes.

HYDRAULIC DATA

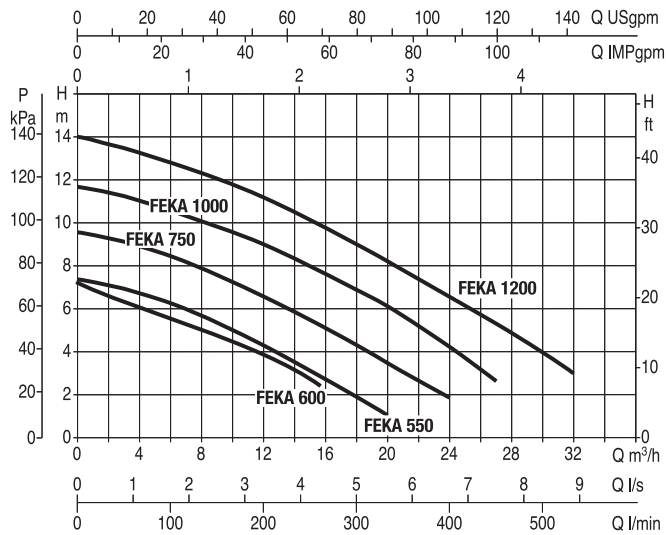

DIMENSIONS AND WEIGHTS

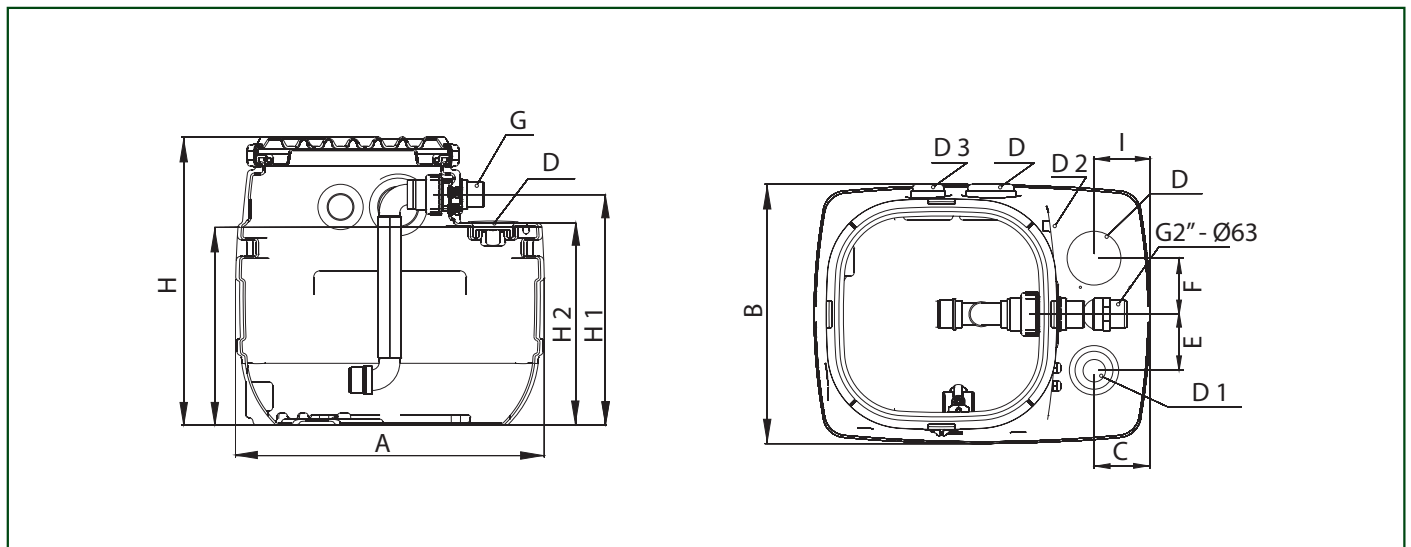

MODEL	A	B	C	D	D1	D2	D3	E	F	G	H	H1	H2	I	WEIGHT Kg.
FEKABOX 200	750	579	124,5	DN 110	DN 50/110	DN 75	DN 110	125	125	2"	700	560	490	124,5	18

NEW



FEKABOX 280

AUTOMATIC STATIONS FOR COLLECTING AND LIFTING WASTE WATER



Automatic collection and lifting stations, used for collecting and pumping civil and industrial waste water in sewers.

Comprises a high density 280 litre polythene tank with removable cover complete with a watertight and gastight seal. Complete with lifting device (DSD2) for making pump maintenance easier.

Fitted for one automatic electric pump (**FEKA 600 M-A - FEKA VS 550 M/A - FEKA VS 750 M/A - FEKA VX 550 M/A - FEKA VX 750 M/A**) to be ordered separately.

Complete with: special cable holder, DN50 and DN110 suction manifolds and 2" delivery manifolds.

Complete with connector for DN50 vent tube. An alarm float can be used on request.

Operating range: from 1 to 24 m³/h with a head of up to 9 m

Liquid temperature range: +50°C

Pumped liquid: ground water, rain water, clear waste water, black waste water and water from rivers and lakes.

HYDRAULIC DATA

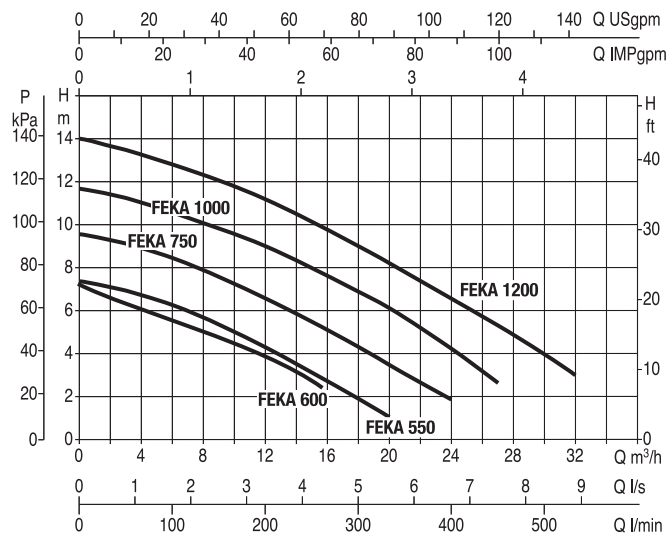

DIMENSIONS AND WEIGHTS

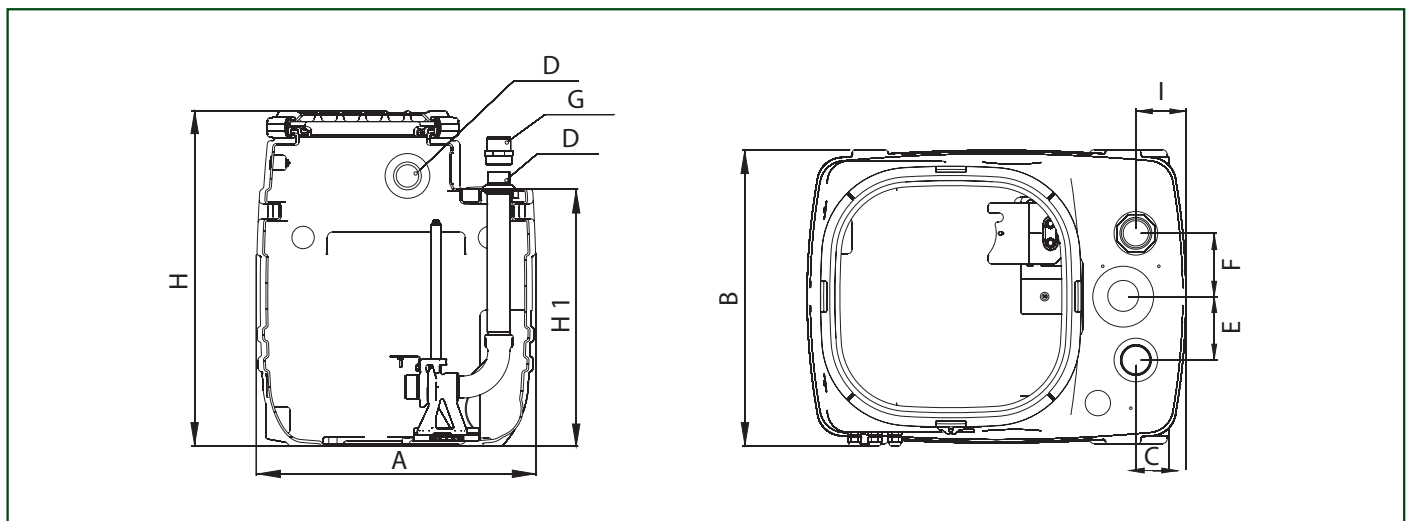

MODEL	A	B	C	D	E	F	G	H	H1	I	WEIGHT Kg.
FEKABOX 280	750	585	99	DN 50/110	125	125	2" - 0.63	900	690	124.5	34

NEW



FEKAFOS 200

AUTOMATIC STATIONS FOR COLLECTING AND LIFTING WASTE WATERS



Automatic collection and lifting stations, used for collecting and pumping civil and industrial waste water in sewers.

Comprises a high density 200 litre polythene tank with removable cover complete with a watertight and gastight seal.

Fitted for one non-automatic electric pump (**FEKA 600 M-NA - FEKA VS-VX 550 M-NA /T-NA - FEKA VS-VX 750 M-NA/T-NA - FEKA VS-VX 1000 M-NA/T-NA - FEKA VS-VX 1200 M-NA/T-NA**) to be ordered separately.

Complete with: 2 bulb floats mounted on a stainless steel support, cable holder for connecting the float and pump cables to the electrical panel (**to order separately according to the table**).

Complete with DN50 and DN110 suction manifolds and 2" delivery manifolds.

Complete with connector for DN50 vent tube.

An alarm float can be used on request.

Operating range: from 1 to 35 m³/h with a head of up to 9 m

Liquid temperature range: +50°C

Pumped liquid: ground water, rain water, clear waste water, black waste water and water from rivers and lakes.

ELECTRICAL AND HYDRAULIC DATA

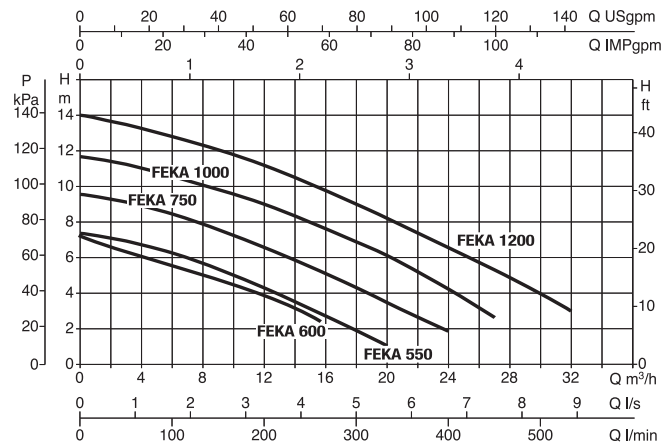

MODEL	P2 NOMINAL		CONTROL PANEL SINGLE-PHASE 230V~ 50 Hz	CONTROL PANEL THREE-PHASE 400V~ 50 Hz
	kW	HP		
FEKA 600 N.A.	0,55	0,75	ED1,3 M	ED1 T
FEKA VS-VX 550 N.A.	0,55	0,75	ED1,3 M	ED1 T
VS-VX 750 N.A.	0,75	1	ED1,3 M	ED1 T
FEKA VS-VX 1000 N.A.	1	1,36	ED1,3 M	ED1,5 T
FEKA VS-VX 1200 N.A.	1,2	1,6	ED1,3 M	ED1,5 T

DIMENSIONS AND WEIGHTS

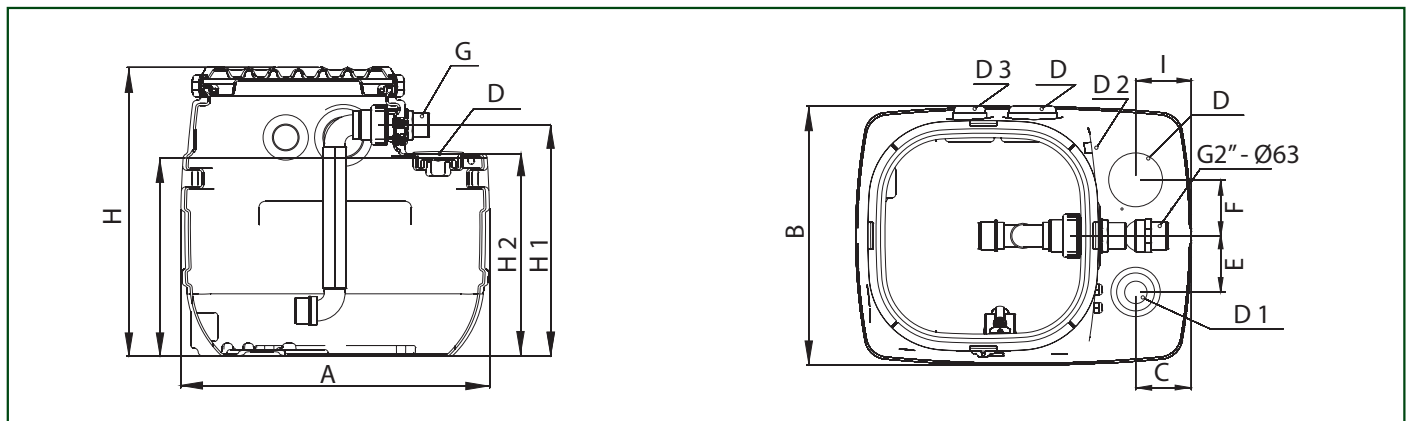

MODEL	A	B	C	D	D1	D2	D3	E	F	G	H	H1	H2	I	WEIGHT Kg.
FEKAFOS 200	750	579	124,5	DN 110	DN 50/110	DN 50	DN 75	125	125	2"	700	560	490	124,5	18

NEW



FEKAFOS 280 DOUBLE

AUTOMATIC STATIONS FOR COLLECTING AND LIFTING WASTE WATERS



Automatic collection and lifting stations, used for collecting and pumping civil and industrial waste water in sewers.

Comprises a high density 280 litre polythene tank with removable cover complete with a watertight and gastight seal. Complete with two lifting devices (DSD2) for making pump maintenance easier. Fitted for two non-automatic electric pumps (**FEKA 600 M-NA - FEKA VS-VX 550 M-NA /T-NA - FEKA VS-VX 750 M-NA /T-NA - FEKA VS-VX 1000 M-NA /T-NA - FEKA VS-VX 1200 M-NA /T-NA**) to be ordered separately.

Complete with: 3 bulb floats mounted on a stainless steel support, cable holder for connecting the float and pump cables to the electrical panel (**to order separately according to the table**).

Complete with DN50 and DN110 suction manifolds and 2" delivery manifolds. Complete with connector for DN50 vent tube.

An alarm float can be used on request.

Operating range: from 1 to 24 m³/h with a head of up to 9 m

Liquid temperature range: +50°C

Pumped liquid: ground water, rain water, clear waste water, black waste water and water from rivers and lakes.

ELECTRICAL AND HYDRAULIC DATA

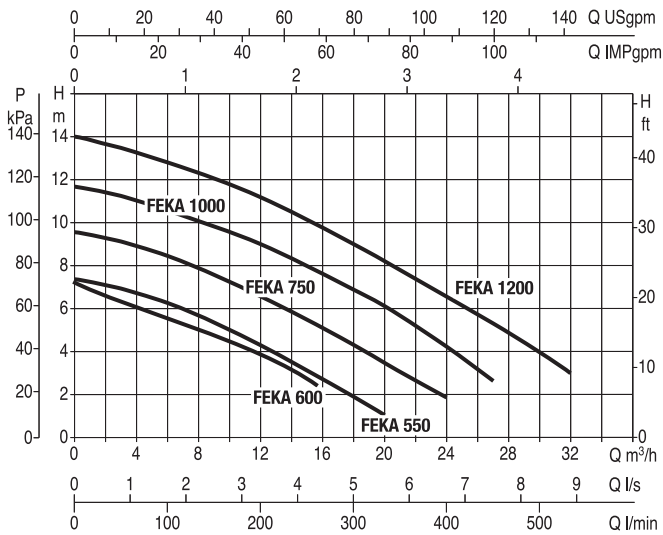

MODEL	P2 NOMINAL		CONTROL PANEL SINGLE-PHASE 230V~ 50 Hz	CONTROL PANEL THREE-PHASE 400V~ 50 Hz
	KW	HP		
2FEKA 600 N.A.	0,55	0,75	E2D2,6 M	E2D2 T
2FEKA VS-VX 550 N.A.	0,55	0,75	E2D2,6 M	E2D2 T
2FEKA VS-VX 750 N.A.	0,75	1	E2D2,6 M	E2D2 T
2FEKA VS-VX 1000 N.A.	1	1,36	E2D2,6 M	E2D3 T
2FEKA VS-VX 1200 N.A.	1,2	1,6	E2D2,6 M	E2D3 T

DIMENSIONS AND WEIGHTS

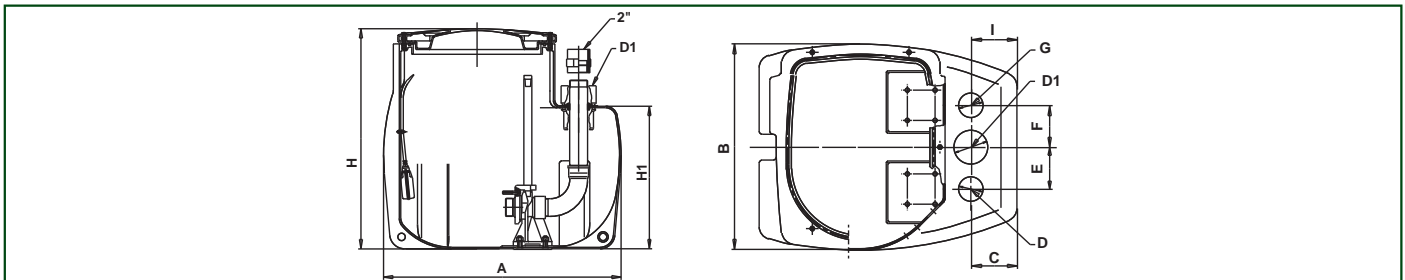

MODEL	A	B	C	D	D1	E	F	G	H	H1	I	WEIGHT Kg.
FEKAFOS 280 DOUBLE/...	800	640	145	DN 50	DN 110	130	130	2"	745	480	145	54